

# General-purpose

General-purpose  
Globe

## Features

1. This is the economical Malleable/ Ductile iron valve. A ready substitute for bronze valves installed with steam piping. A tensile valve.
2. The main parts are mostly stainless steel, which is far more resistant to abrasion than bronze valves.
3. Perfect for iron pipes and resistant to corrosion because of the contact potential difference.

## Product Types

Globe, Gate, Check, Strainer and Mini ball valves

△Caution: Oil specification

1. Can be used with: Heavy oil (A, B, C), lubricant oil, turbine oil (#90 and up), coal tar, pitch
2. Not recommended for use with: Crude oil, naphthalene, gasoline, heating oil (kerosene), light oil, turbine oil (#80 and down), heat transfer oil

## Fluid • Temperature • Pressure

Unit: MPa

Service temperature limit by fluid used (°C)		Steady water flow			Steam, air, gas, oil, pulsating water					LPG		City gas
		50	80	120	80	120	160	183	220	80	120	120
Globe	Standard			1.37					0.98			
	Reinforced PTFE disc			1.37				0.98				
	For LPG					0.98					0.19	
Gate/Strainer				1.37					0.98			
Check	Standard			1.37					0.98			
	Reinforced PTFE disc			1.37					0.98			
	NBR disc		1.37		0.98							
	Inline			1.37			0.98					
Mini ball	600 model	4.11			0.98 (air)	1.96 (oil)		0.98 (steam)				
	400 model	2.74			0.98 (air)	1.96 (oil)		0.98 (steam)				
	For LPG									0.19		
	For city gas											0.098

## Test Pressure

Unit: MPa

Model	Test description	Valve body pressure resistance		Valve seat leakage	
		Water pressure	Air pressure	Water pressure	Air pressure
Globe, Gate, check valves		2.06		1.51	
Globe valve for LPG		0.78			0.29
Strainer		2.06			
Mini ball	MB2-MBT2-UB2-UBT2	6.18			0.59
	MB1-MBT1	4.12			0.59
	ML1-MLC1		0.29		0.29
	MG1-MGC1-MGR0		0.15		0.15

Product Code **HM10KST**

General-purpose 10K **Strainer Screwed**

Product Name	Material	Remarks
Body	FCMB-S35	
Cover	FCMB270	
Screen	SUS304	20 mesh
L-ring	SUS304	
Spring	SWC	
Plug	S20C	Nominal diameter: ¼-¾B
	FCMB270	Nominal diameter: 1-2B

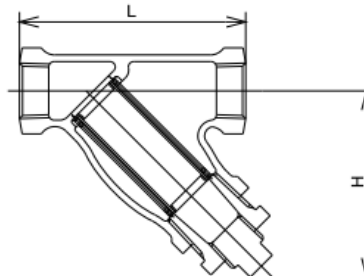

Nominal diameter (B)	1/4	3/8	1/2	3/4	1	1¼	1½	2
L	65	70	85	85	100	120	135	160
H	54	55	70	75	82	94	106	125