

TS1



Features

To check operation of steam traps

Suitable for

Steam and liquid lines

T3



Dimensions TS1

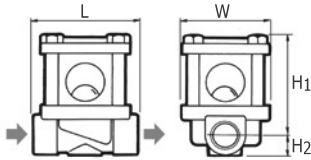

T3

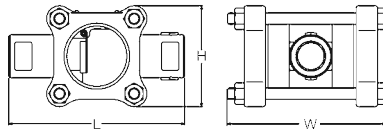

T3F

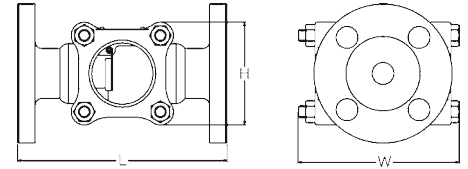

Model	Connect.	Size	Max. Operating Pressure		Max. Operating Temperature		Dimensions (mm)					Dimensions (in)					Body Material	Weight			
			MPa	psi	°C	°F	L	H	H1	H2	W	L	H	H1	H2	W		kg	lb		
TS1	Screwed Rc, NPT	1/2"	0,8 Steam	116 Steam	180 Steam	356 Steam	80	69	14	60	3.1	2.7	0.5	2.4	Brass C3771	0,9	1.8				
		3/4"	1,0 Water	145 Water	100 Water	212 Water										71	17	2.8	0.7	1,0	2.0
		1"	0,97 Air	140 Air	100 Air	212 Air										85	76	3.0	0.8	1,2	2.2
T3	Screwed Rc, NPT	1/2"	1,0	145	183	361	123	70	110	4.8	2.8	4.3	Cast Steel A216WCB	1,6	3.5						
		3/4", 1"												1,7	3.7						
		1 1/4"												3,3	7.3						
		1 1/2"												3,2	7.0						
		2"												195	115	185	7.7	4.5	7.3	Cast Iron FC200	7,3
T3F	Flanged JIS, ASME, DIN	1/2"	1,0	145	183	361	144	70	110	5.7	2.8	4.3	Cast Steel A216WCB	3,3	7.3						
		3/4"												4,4	9.7						
		1"												5,0	11.0						
		1 1/4"												8,0	17.6						
		1 1/2"												9,0	19.8						
		2"												210	115	185	8.3	4.5	7.3	Cast Iron FC200	12,0

Spare Parts

