

# General-purpose

General-purpose  
Globe

## Features

1. This is the economical Malleable/Ductile iron valve. A ready substitute for bronze valves installed with steam piping. A tensile valve.
2. The main parts are mostly stainless steel, which is far more resistant to abrasion than bronze valves.
3. Perfect for iron pipes and resistant to corrosion because of the contact potential difference.

## Product Types

Globe, Gate, Check, Strainer and Mini ball valves

△Caution: Oil specification

1. Can be used with: Heavy oil (A, B, C), lubricant oil, turbine oil (#90 and up), coal tar, pitch
2. Not recommended for use with: Crude oil, naphthalene, gasoline, heating oil (kerosene), light oil, turbine oil (#80 and down), heat transfer oil

## Fluid • Temperature • Pressure

Unit: MPa

Service temperature limit by fluid used (°C)	Steady water flow			Steam, air, gas, oil, pulsating water				LPG		City gas		
	50	80	120	80	120	160	183	220	80	120	120	
Globe	Maximum working pressure by product type MPa											
	Standard		1.37					0.98				
	Reinforced PTFE disc		1.37				0.98					
For LPG					0.98					0.19		
Gate/Strainer			1.37					0.98				
Check	Standard		1.37					0.98				
	Reinforced PTFE disc		1.37					0.98				
	NBR disc		1.37	0.98								
	Inline		1.37			0.98						
Mini ball	600 model		4.11		0.98 (air)	1.96 (oil)		0.98 (steam)				
	400 model		2.74		0.98 (air)	1.96 (oil)		0.98 (steam)				
	For LPG									0.19		
	For city gas										0.098	

## Test Pressure

Unit: MPa

Test description	Valve body pressure resistance		Valve seat leakage	
	Water pressure	Air pressure	Water pressure	Air pressure
Globe, Gate, check valves	2.06		1.51	
Globe valve for LPG	0.78			0.29
Strainer	2.06			
Mini ball	MB2·MBT2·UB2·UBT2			0.59
	MB1·MBT1			0.59
	ML1·MLC1		0.29	0.29
	MG1·MGC1·MGR0		0.15	0.15

Product Code **MB2**

General-purpose 10K Mini Ball Valve for General Use Lever Handle, 2-stage Reduced Bore

Product Name	Material	Remarks
Body	FCMB340	Hot dip galvanizing Electro galvanizing
Ball	C3604	Ni-Cr plating
Stem	C3604	Ni-Cr plating
Seat ring	Reinforced PTFE	
Gland Packing	Reinforced PTFE	
Handle	SUS430	PVC coating Color: Orange

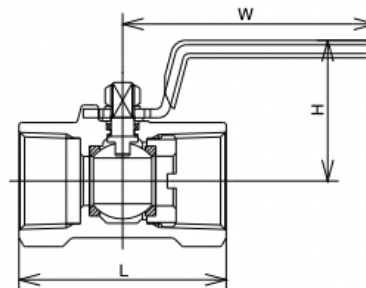

Nominal diameter (B)	1/4	3/8	1/2	3/4	1	1¼	1½	2
L	43	46.5	54	61	71	82	88.5	105
H	32	40	42	47	50	58	62	69
W	62	72	72	87	87	127	127	127